

# CROSS POINT

---

20022 N. 31ST AVENUE, PHOENIX, AZ 85027







Reimagine  
**Your Workplace**

# Property Highlights



TWO, 4 STORY  
**BUILDINGS**

**24** ACRE  
SITE

ON-SITE  
**FITNESS**



TENANT LOUNGE  
& GAME ROOM

ON-SITE CONFERENCE /  
TRAINING CENTER

**3 46,000 SF**  
FLOOR PLATES

ON-SITE  
**FOOD  
SERVICE**



**6/1,000**  
PARKING RATIO  
— 7/1,000 AVAILABLE —

WALKABLE  
**RETAIL**



**3 350,000**  
SQUARE FEET

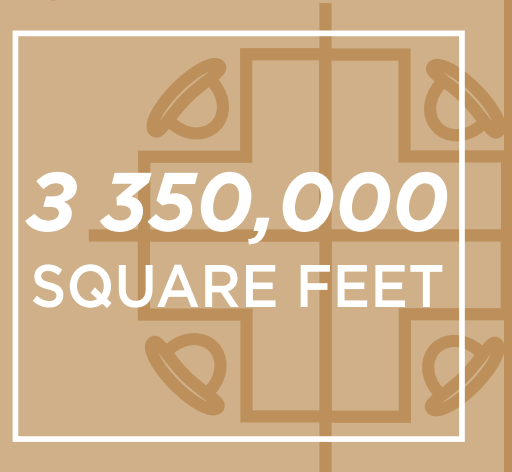



# Common Areas



CAFE AREA

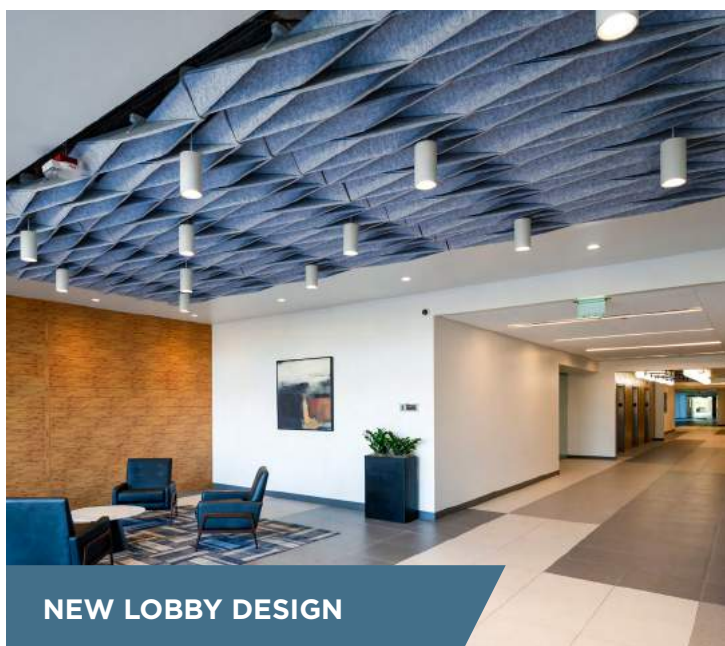

NEW LOBBY DESIGN

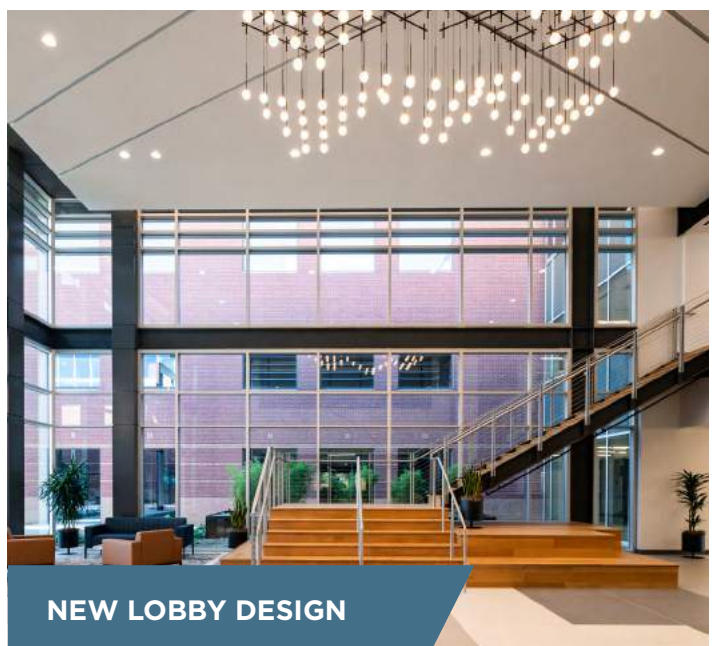

NEW LOBBY DESIGN



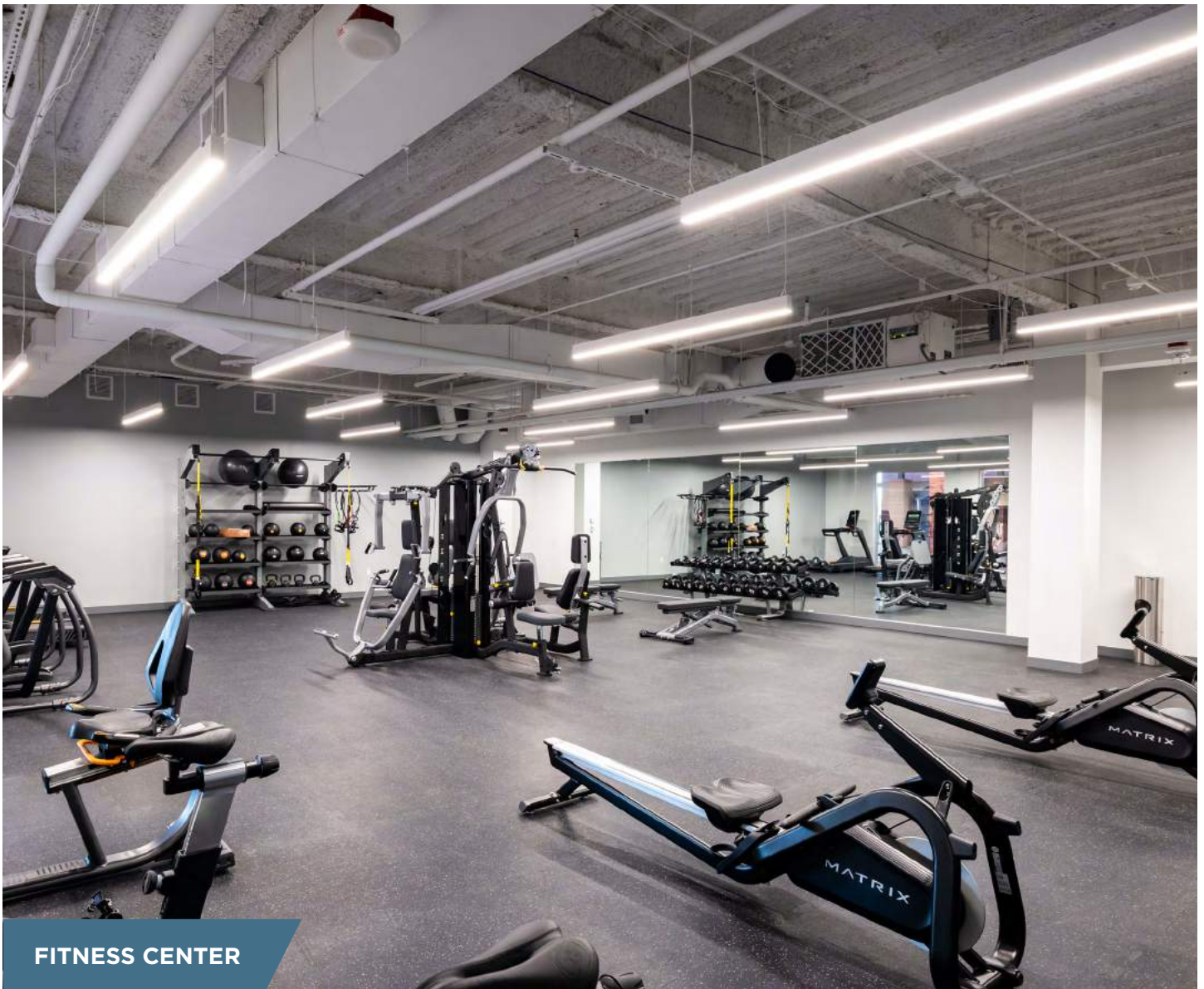

**FITNESS CENTER**

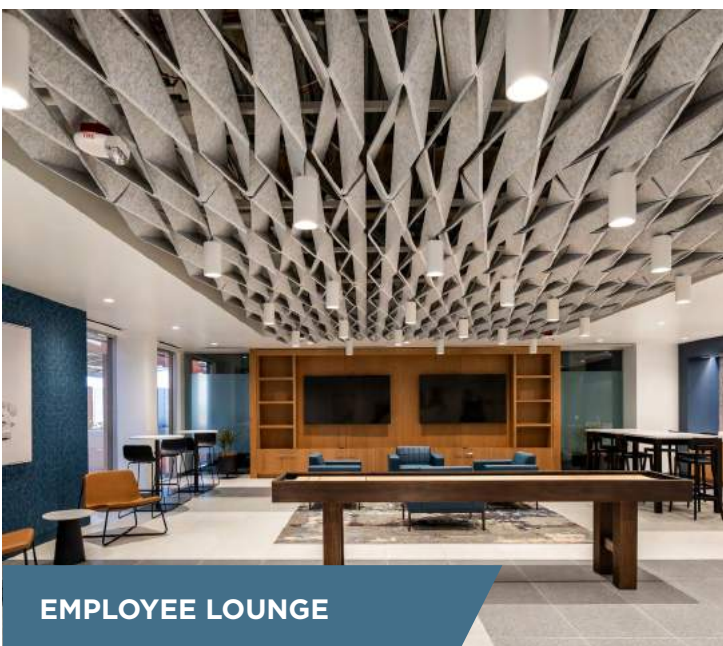

**EMPLOYEE LOUNGE**



**CONFERENCE ROOM**

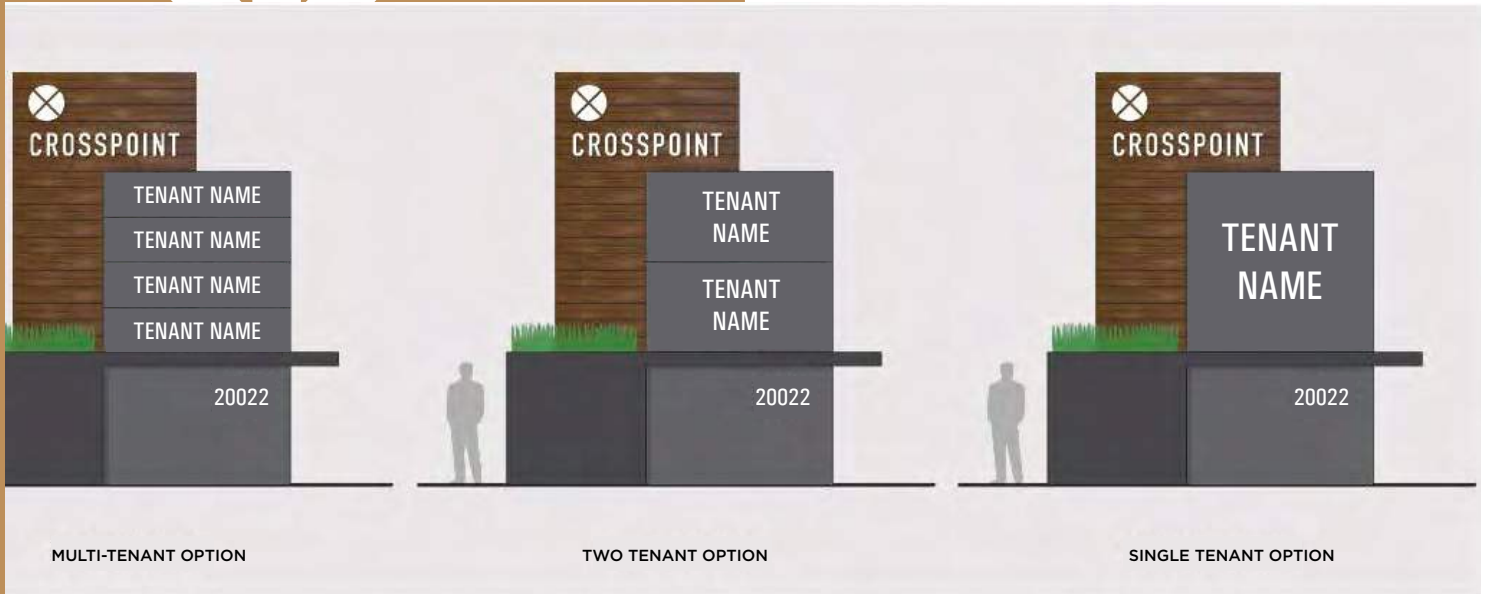
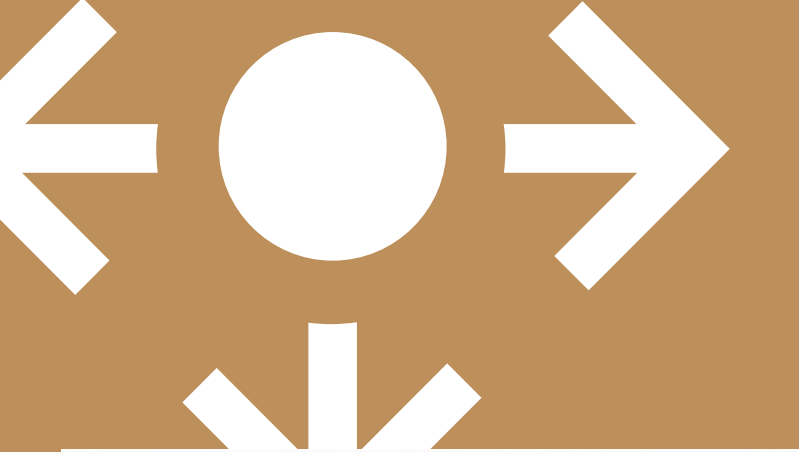

## Tenant Signage Options





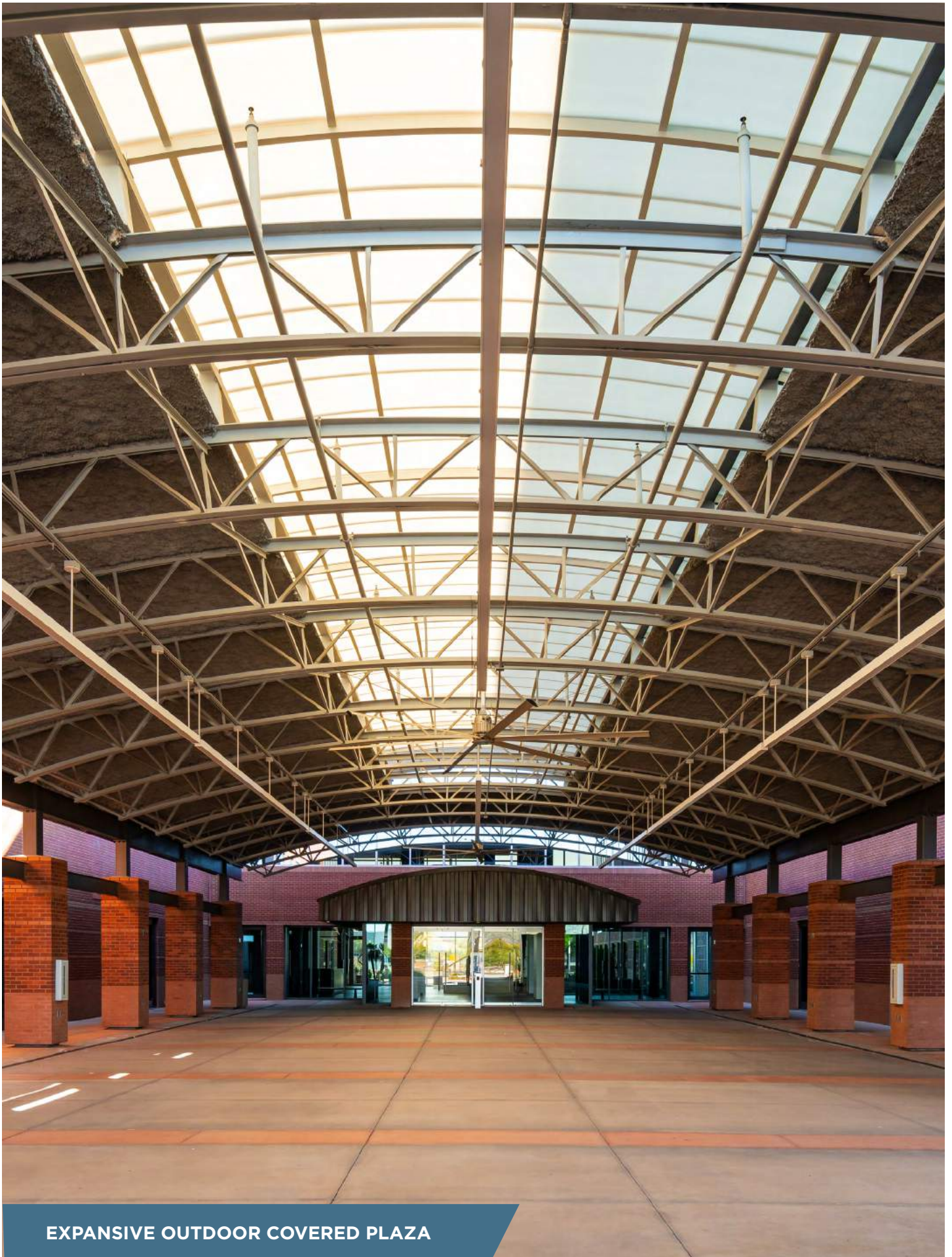

EXPANSIVE OUTDOOR COVERED PLAZA



# → Floor Plates









# Site Plan

- 1 VISITOR ENTRY  
ON 31<sup>ST</sup> AVE
- 2 ADDITIONAL  
VISITOR PARKING
- 3 NEW BUILDING  
LOBBIES
- 4 NEW OUTDOOR  
AMENITY SPACE



SOUTH BUILDING ENTRY







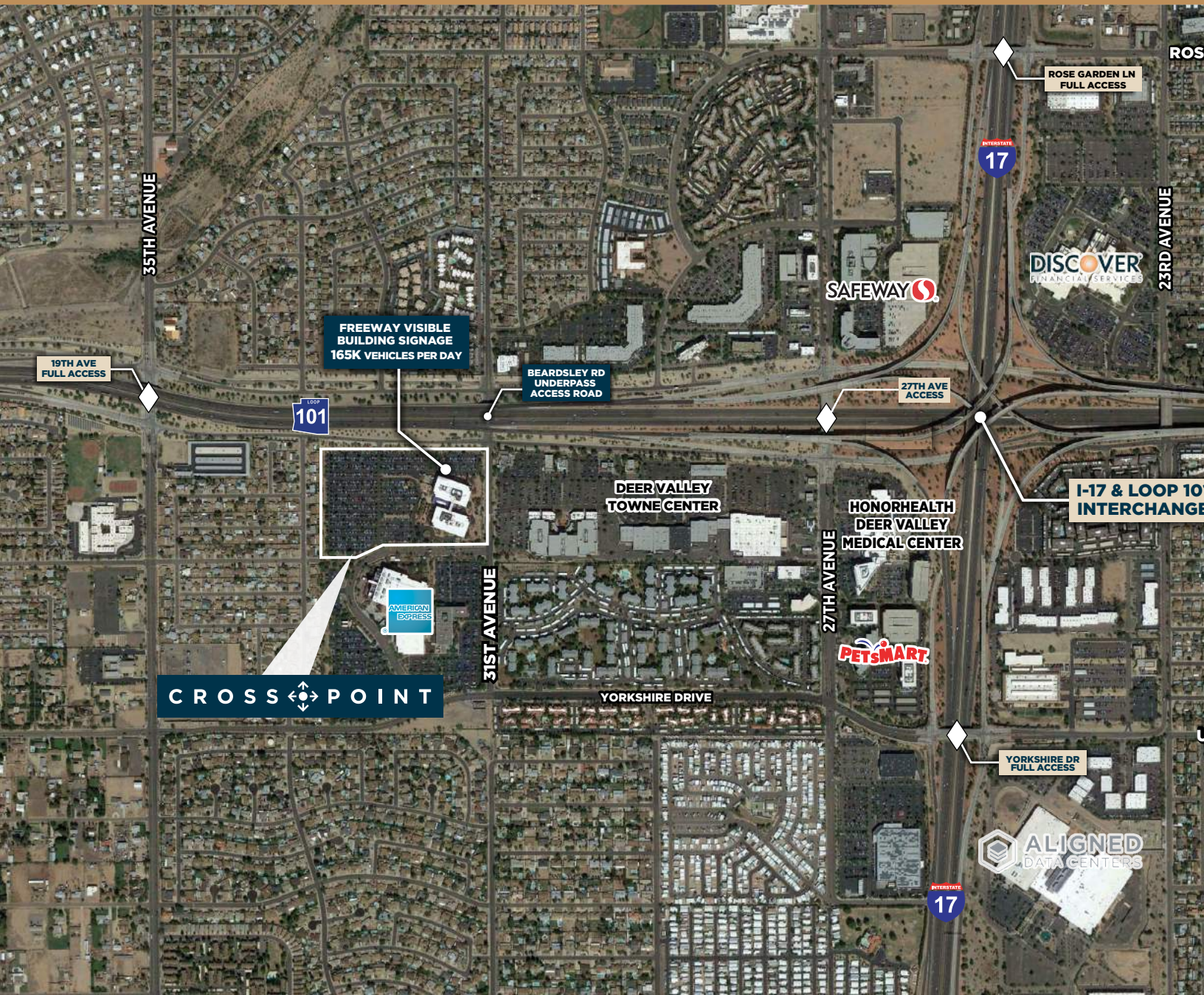



# Area Amenities



MAJOR CORPORATE  
*NEIGHBORS*

**1.2M** PEOPLE  
WITHIN  
10 MIN

**0.1 MILES**  
TO LOOP 101

**0.8 MILES**  
TO I-17

LOCATED IN THE HEART OF  
THE DEER VALLEY CORE

CLOSE PROXIMITY  
TO 8 MASTER  
PLANNED COMMUNITIES

**46**  
*HOTELS*  
WITHIN 10 MINUTES

**459+**  
RESTAURANTS  
WITHIN  
10 MINUTES

**30 MIN**  
FROM SKY HARBOR  
INTERNATIONAL AIRPORT



# Walkable Amenities





# Area Employers



CHUBB®

SAFEWAY

COX

Honeywell

OneAZ  
CREDIT UNION

Cigna

WELLS  
FARGO

Cognizant

AMERICAN  
EXPRESS

PETSMART

WM  
WASTE MANAGEMENT

ALIGNED  
DATA CENTERS

USAA®

BW Best  
Western.

DISCOVER  
FINANCIAL SERVICES

AG  
Communication  
Systems  
A Subsidiary of Lucent Technologies



# CROSS POINT

20022 N. 31ST AVENUE  
PHOENIX, AZ 85027

**Mike Beall**

+1 602 224 4426

[mike.beall@cushwake.com](mailto:mike.beall@cushwake.com)

**Chris Walker**

+1 602 224 4466

[chris.walker@cushwake.com](mailto:chris.walker@cushwake.com)

**Jeff Wentworth**

+1 602 224 4423

[jeff.wentworth@cushwake.com](mailto:jeff.wentworth@cushwake.com)



**CUSHMAN &  
WAKEFIELD**



**Peakstone**  
REALTY TRUST

2555 East Camelback Road, Suite 400, Phoenix, Arizona 85016 | P +1 602 954 9000  
[cushmanwakefield.com](http://cushmanwakefield.com)

©2023 Cushman & Wakefield. All rights reserved. The information contained in this communication is strictly confidential. This information has been obtained from sources believed to be reliable but has not been verified. NO WARRANTY OR REPRESENTATION, EXPRESS OR IMPLIED, IS MADE AS TO THE CONDITION OF THE PROPERTY (OR PROPERTIES) REFERENCED HEREIN OR AS TO THE ACCURACY OR COMPLETENESS OF THE INFORMATION CONTAINED HEREIN, AND SAME IS SUBMITTED SUBJECT TO ERRORS, OMISSIONS, CHANGE OF PRICE, RENTAL OR OTHER CONDITIONS, WITHDRAWAL WITHOUT NOTICE, AND TO ANY SPECIAL LISTING CONDITIONS IMPOSED BY THE PROPERTY OWNER(S). ANY PROJECTIONS, OPINIONS OR ESTIMATES ARE SUBJECT TO UNCERTAINTY AND DO NOT SIGNIFY CURRENT OR FUTURE PROPERTY PERFORMANCE. COE-PM-