



CROSS  POINT



Reimagine  
**Your Workplace**



**CROSSPOINT:** Reimagine your workplace





TWO, 4 STORY  
BUILDINGS



24  
ACRE SITE



± 46,000 SF  
FLOOR PLATES

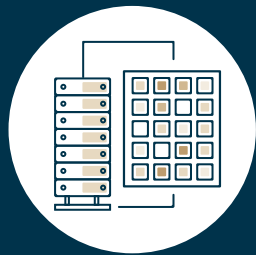

FULL DATA CENTER  
INFRASTRUCTURE



ON-SITE  
**FOOD SERVICE**



ON-SITE  
**FITNESS**



6/1,000  
PARKING RATIO  
— 7/1,000 AVAILABLE —

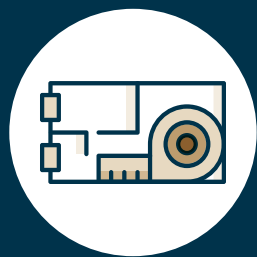

± 350,000  
SQUARE FEET

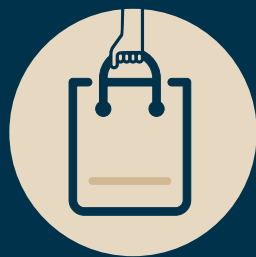

WALKABLE  
**RETAIL**







VISITOR ENTRY PLAZA

VISITOR DROP-OFF





FITNESS CENTER WITH  
LOCKER ROOM AND SHOWERS



FULL SERVICE CAFE



EMPLOYEE LOUNGE



CONFERENCE CENTER



OUTDOOR ENGAGEMENT AREAS





NEW TWO STORY LOBBY ENTRANCE









CAFE AREA

SIGNAGE OPTIONS



VISITOR/EMPLOYEE ENTRANCE



NEW LOBBY DESIGN



NEW LOBBY DESIGN



31<sup>ST</sup> AVE MONUMENT SIGN



SITE PLAN CHANGES

6/1000 PARKING RATIO



- 1 VISITOR ENTRY ON 31<sup>ST</sup> AVE
- 2 ADDITIONAL VISITOR PARKING
- 3 NEW BUILDING LOBBIES
- 4 NEW OUTDOOR AMENITY SPACE





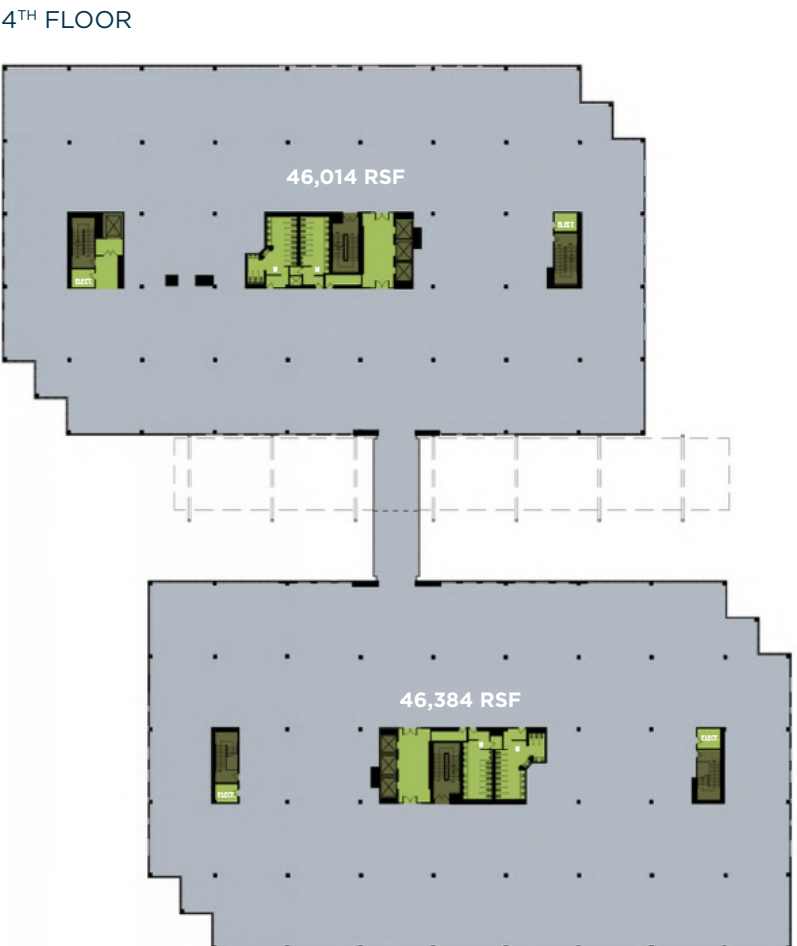
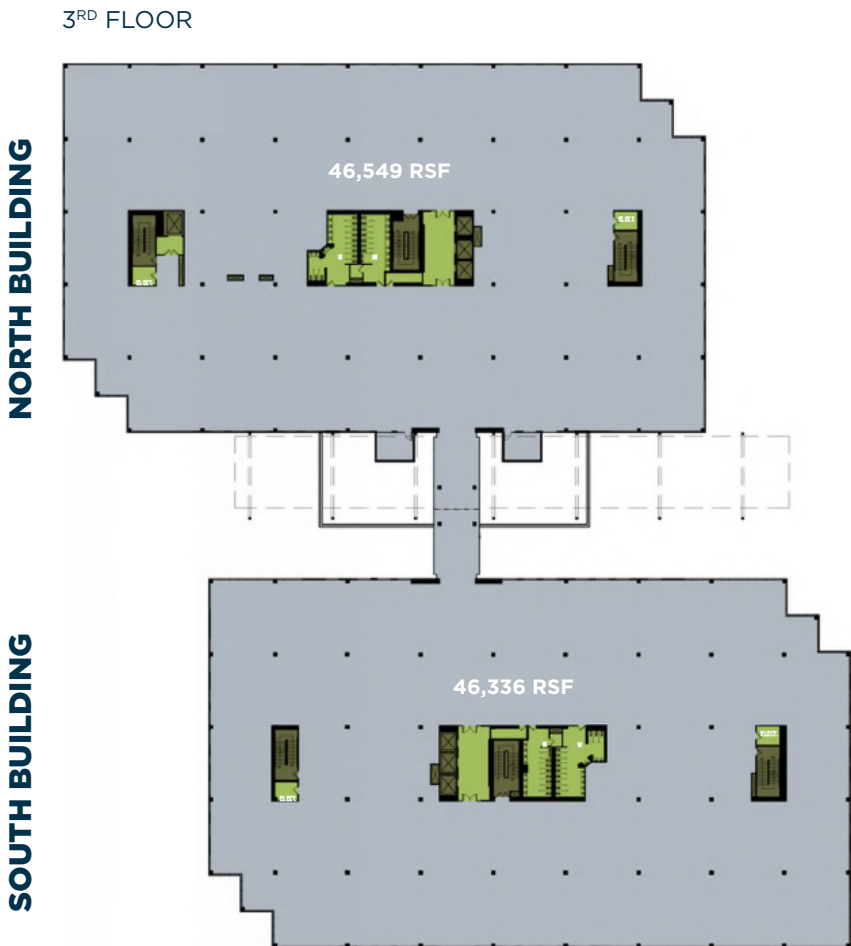
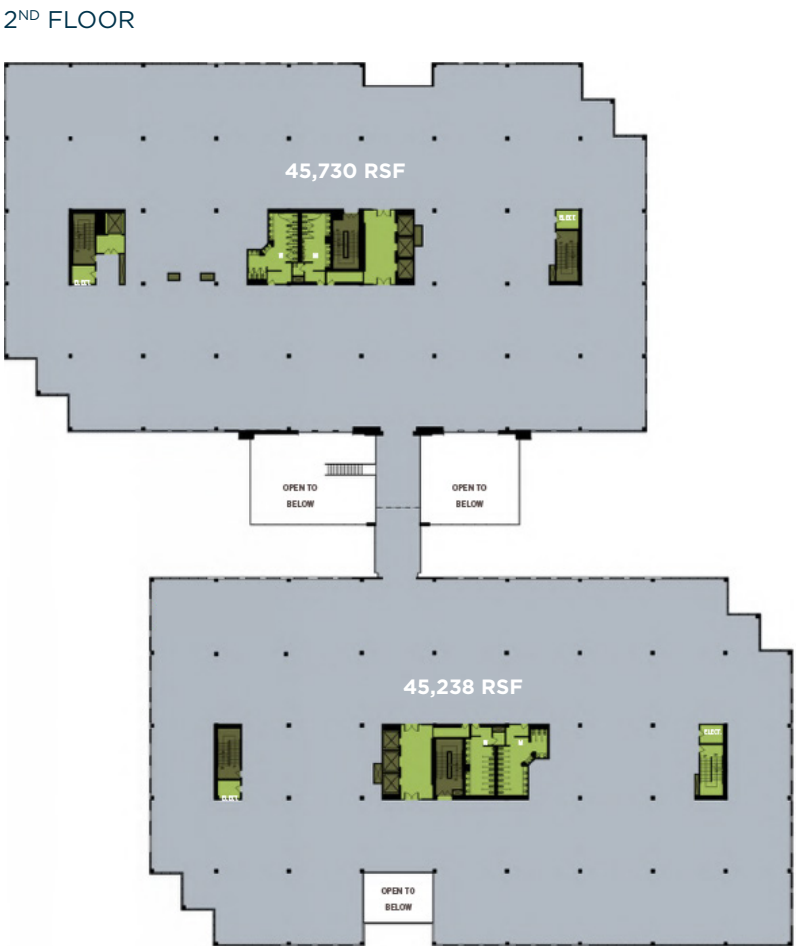
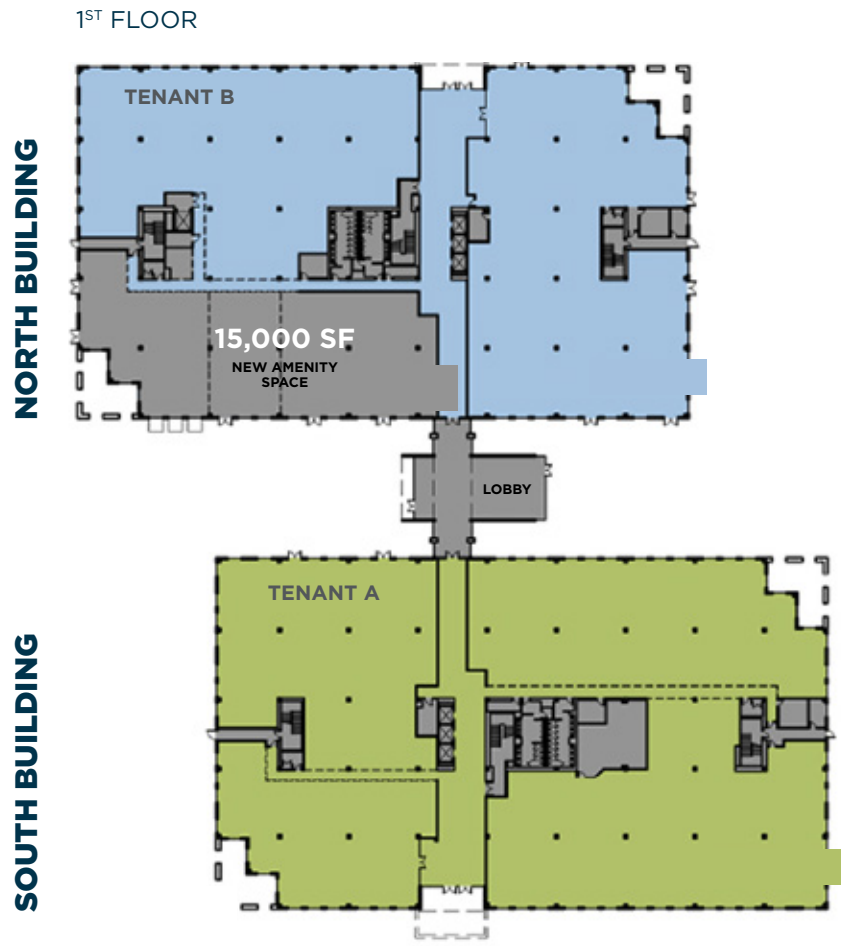



LOCATION OVERVIEW



46

HOTELS

within 10 minutes

0.1

MILES

TO



LOOP 101



0.8 MILES

TO



11

MAJOR

CORPORATE

NEIGHBORS



459+

RESTAURANTS

WITHIN

10 MINUTES



1.2M

PEOPLE

within 20

MINUTES

AREA AMENITIES



Reimagine Your Workplace



LOCATED IN THE HEART  
OF THE DEER VALLEY CORE



30 MINUTES  
FROM SKY HARBOR  
INTERNATIONAL AIRPORT



CLOSE PROXIMITY  
TO 8 MASTER PLANNED  
COMMUNITIES



IMMEDIATE ACCESS TO  
LOOP 101 AND I-17



WALKABLE AMENITIES

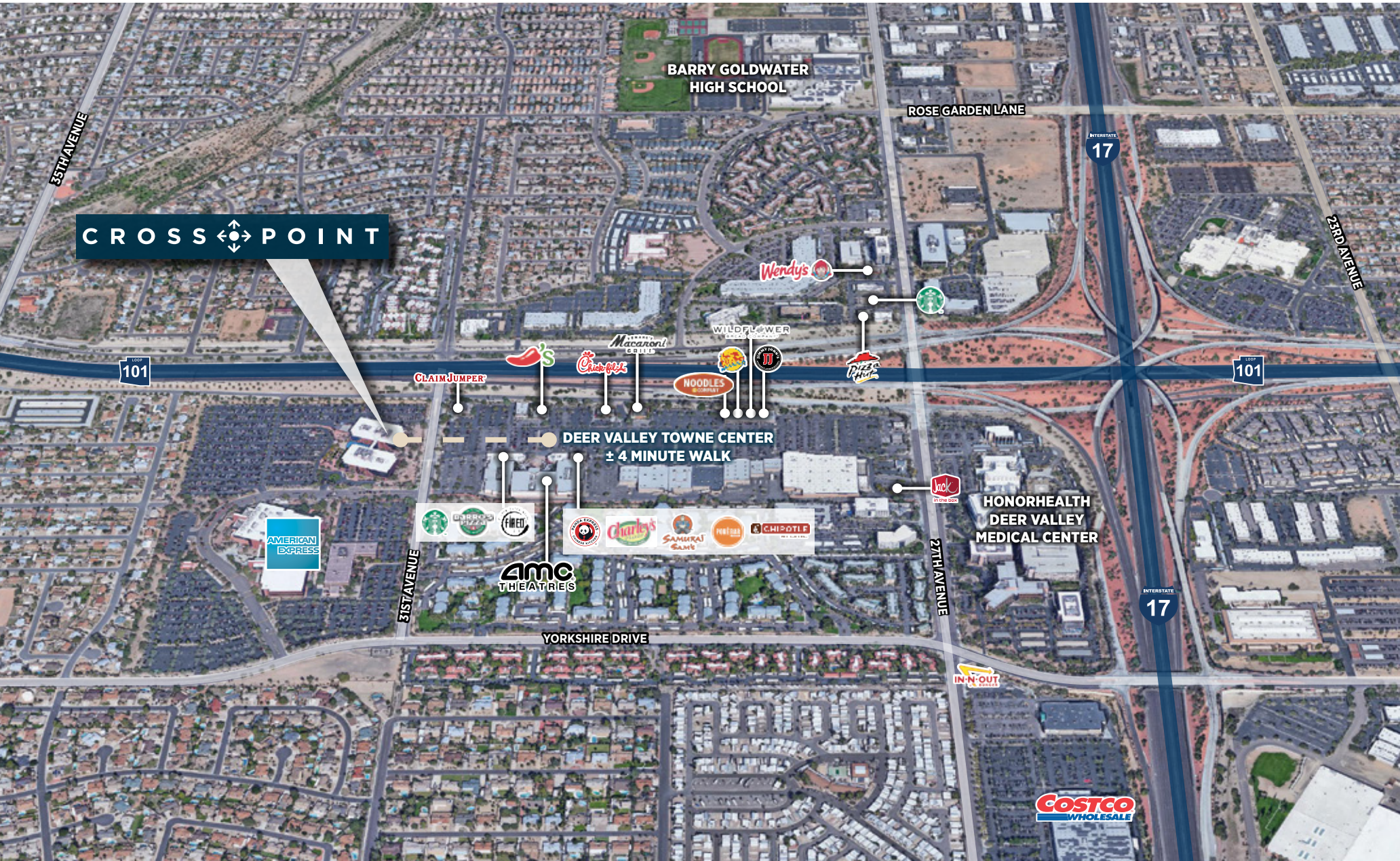

Reimagine **Your Workplace**

WALKABLE AMENITIES

17 WALKABLE RESTAURANTS





AREA EMPLOYERS

CHUBB®

SAFEWAY

ALIGNED  
DATA CENTERS

COX

BW Best  
Western

Honeywell

AMERICAN  
EXPRESS

PETSMART

AG  
Communication  
Systems  
A Subsidiary of Lucent Technologies

USAA®

Cigna

WELLS  
FARGO

DISCOVER  
FINANCIAL SERVICES

Reimagine Your Workplace

AREA EMPLOYERS



AREA OVERVIEW





## LEASING CONTACTS

**Mike Beall**  
+1 602 224 4426  
[mike.beall@cushwake.com](mailto:mike.beall@cushwake.com)

**Jeff Wentworth**  
+1 602 224 4423  
[jeff.wentworth@cushwake.com](mailto:jeff.wentworth@cushwake.com)

**Chris Walker**  
+1 602 224 4466  
[chris.walker@cushwake.com](mailto:chris.walker@cushwake.com)

2555 East Camelback Road, Suite 400, Phoenix, Arizona 85016 | P +1 602 954 9000  
[cushmanwakefield.com](http://cushmanwakefield.com)

